

HOW TO SERVICE YOUR LEWMAR WINCH



Dear Owner

Lewmar winches are known world wide for their quality, technical innovation and performance. They have been tested to their limits by our engineers in the laboratory and by racing crews in their search for victory. They have given years of outstanding service to many thousands of yachtsmen to whom the ultimate performance of a yacht or its equipment is perhaps not so important as the pure joy of sailing a fine craft equipped with the best yacht hardware.

This booklet tells you how to give your Lewmar winches the care and attention they need to ensure that whether you sail for results, records or just pleasure, your winches will contribute that extra level of performance that is designed into each Lewmar winch.

Service details of the current range of Lewmar winches are illustrated in this booklet.

The overall servicing principles may be used for earlier versions although the detailed construction of the winches may be different.

Your Lewmar winches have been selected to perform in the best possible manner, with care and attention they will give many years use.

Incidentally, you may like to know that we're the only winch-maker to offer a total sailing system... system Lewmar. System Lewmar includes winches, blocks, shackles, travellers and hatches, portlight, all designed as a family, all working together in harmony. Included in System Lewmar is our range of patented 'WAVEGRIP'® Self Tailing Winches.

If you've ever found yourself short of hands, space, or just plain old muscle power a couple of Lewmar self tailing winches will make all the difference. By freeing you of the necessity to tail the sheet a self tailer enables you to use both hands to wind.

Lewmar's patented Wavegrip concept is simple, safe, and convenient... aren't those the features you're looking for.

All precision-engineered by Lewmar to take you closer to the ultimate sailing experience. For further details, see page 26.

Lewmar wish you good sailing for many years to come.

Lewmar Marine Ltd.

Our guarantee of quality

Lewmar winches have been developed over many years by extensive testing aboard the world's finest racers, long distance cruising yachts and match racing yachts such as 12 metres. They are manufactured to quality standards in excess of those required by Lloyds and only the finest materials are used.



If installed, used and maintained as described in this booklet, they will give outstanding performance.

Lewmar undertake that any winch which proves defective in materials or workmanship within 1 year of the date of supply will be repaired

or replaced **FREE OF CHARGE** provided that the winch is returned by the registered owner to the nearest Lewmar office or distributor for examination. Lewmar reserve all rights on determining the nature of the alleged fault and their decision is final.

Contents	Page
When Do Lewmar Winches Need Servicing?	4
What Do I Need - Tools, Spares Kits, Service Manuals	4 & 5
Fitting Your Lewmar Winch	6
Using Self Tailing Winches	7
Self Tailer Adjustment - 16ST to 65ST	8
Servicing Single Speed Winches - 6, 7, 8	9
Servicing Two Speed Winches - 16, 24, 30, 40, 43, 46, 52	10-12
Servicing Three Speed Winches - 48, 55, 65	13-15
Servicing Halliard Winch - No. 1	16
Servicing One Speed Self Tailing Winches - 16ST	17
Servicing Two Speed Self Tailing Winches - 30ST, 40ST, 43ST, 46ST, 48ST, 52ST, 55ST, 65ST	18-22
Servicing Three Speed/Three Gear 55/3, 65/3, Standard and Self Tailing Winches	23
Servicing Electric Winches	24
Your Lewmar Guarantee and Counterfoil	25
Enquiry Card (including guarantee return) for Information on Other Lewmar Products	26
Lewmar Distributor and Service Addresses	26-27

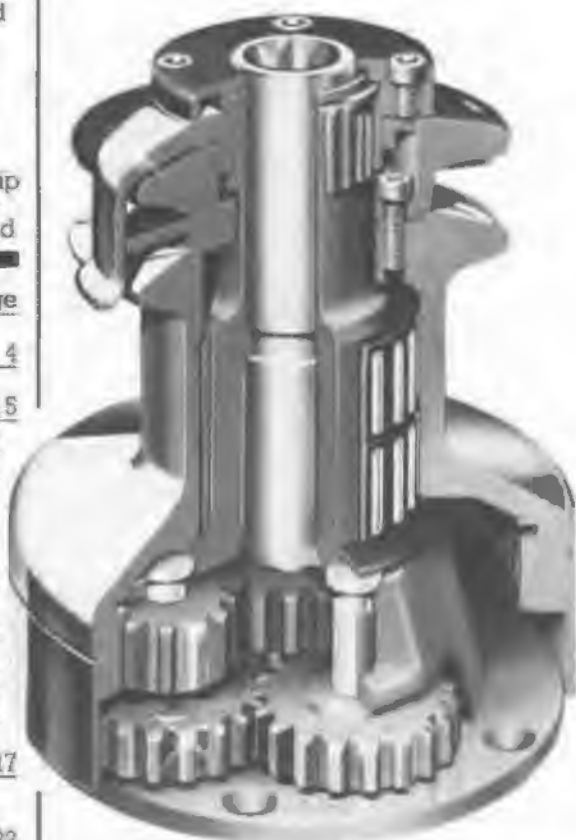

System

LEWMAR

Integrated Sailing Systems

WHEN TO SERVICE.

Frequency of Servicing

Lewmar winches, like any other precision engineered product, must be serviced regularly. Yacht winches are required to carry deceptively high loads. For example the genoa sheet load on a 40 foot cruising yacht could easily be 1000lbs. Regular servicing with attention to correct assembly and condition of parts is vital.

When?

1. **MONTHLY:** All Lewmar sheet winches should be lightly oiled and greased as shown.

2. **TWO OR THREE TIMES DURING ACTIVE SAILING SEASON:** All Lewmar winches should be stripped, cleaned and re lubricated.

3. **AT THE END OF EACH SAILING SEASON AND BEFORE STARTING THE NEW SAILING SEASON:** All Lewmar winches should be completely stripped, cleaned, thoroughly checked for damage and lubricated using the full maintenance manual.

General External Cleaning of Drum

Chromed Winches - Wash drum regularly with fresh water and dry with chamois leather.

OCCASIONALLY use non abrasive liquid chrome cleaner to remove dirt deposits.

Anodised Aluminium Winches - Wash drum regularly with fresh water and dry with chamois leather. **DO NOT USE POLISHES OR ABRASIVES.**

Stainless Steel Winches - Wash drum regularly with fresh water and dry with chamois leather.

OCCASIONALLY use non abrasive liquid cleaner to remove dirt deposits.

WHAT YOU NEED.

WINCH SPARES KIT

Lewmar provide a maintenance kit for each winch in their range. These kits contain parts which owners may damage or mislay. Each kit is complete and parts are not sold separately.

Typical parts include:-

Pawls, springs, circlips, washers, locking caps, etc.

Spares Kits

Ref.

7001 Single speed winches.

7002 Two speed and small self tailing winches up to and including 43 ST.

7003 Three speed push button winches.

7004 Self tailing winches 46ST and above.

7008 Various circlips (Owners are strongly recommended to carry spare circlips for all winches).

7009 Allen key set.

7010 Grease 100g tube.

7011 Grease 300g tub.

Don't forget to get your spares kit from your local dealer before starting a major end of season service.



WHAT TOOLS DO I NEED?

Any winch can be stripped for servicing in seconds, using a very basic set of tools as described in the table below, and winches introduced from December 1983 onwards need nothing more than a cross head screwdriver and cleaning materials

Tools required, for routine servicing

Model	Tools
All models - basic requirement	Small screwdriver or knife blade Clean non-fluffy cloth Cleaning fluid Lubricants
6, 7, 8, 10, 16, 24, 30, 40, 42, 1H 16ST, 30ST, 34ST	basic requirement only plus soft mallet
40ST, 42ST	plus $\frac{3}{16}$ " A/F Allen Key
44, 48, 44ST, 48ST	plus $\frac{7}{16}$ " or $\frac{5}{8}$ " A/F Allen Key
55, 65, 55ST, 65ST	plus $\frac{1}{2}$ " A/F Allen Key
From Dec. 1983 - 16, 24, 30, 40, 43, 46, 52, 16ST, 30ST, 40ST, 43ST, 46ST, 52ST	basic plus cross head screwdriver

SERVICE MANUALS

A full service manual is available from your nearest Lewmar distributor office. Your dealer can supply the correct manual for your particular winch. Full servicing of any winch should not be undertaken without reference to this manual.

For models not mentioned here, please contact your Lewmar offices for service details.

Service Manual Vol IV applies

Winch	Start	End
6, 7, 8	Jan 76	—
16, 24, 30, 40	Mar 84	—
43, 46	Jan 84	—
52	Dec 84	—
48, 55, 65	Jan 84	—
16ST, 40ST	Jan 84	—
30ST, 43ST, 46ST	Mar 85	—
48ST, 55ST, 65ST	Jan 84	—
52ST	Dec 84	—
No. 1 Halliard	Jan 78	—

Service Manual Vol V applies

Winch	Start	End
6	Jan 83	—
7, 8	Jan 85	—
16, 24, 30, 40	May 85	—
43, 46	Mar 85	—
52	Dec 84	—
48, 55, 65	Jan 84	—
16ST, 40ST	Mar 85	—
30ST, 43ST, 46ST	Mar 85	—
48ST, 55ST, 65ST	Jan 84	—
52ST	Dec 84	—
No. 1 Halliard	Jan 78	—

LEWMAR

Service Manual Vol V Specials applies

Winch	Start	End
3 speed, 3 gear 55/3, 65/3	Jan 85	—
3 speed, 3 gear 48ST, 65ST	Jan 85	—
Also coffee grinders and linkage		

SERVICE MANUAL
Volume 5

SERVICE MANUAL
Volume 5
Specials

LEWMAR

FITTING WINCHES



Fitting your winch

To achieve the best bolt and output gear support to optimise performance, we suggest you fit your Lewmar winches in the following manner:-

1. Remove the drum
2. Locate the winch base to achieve the best possible bolt support (see 1,2).
3. Mark the location of the bolt holes
4. Remove the winch
5. Drill the bolt holes
6. Apply bedding compound to the underside, ensuring that each bolt is bedded but keeping the gear spindles clean
7. Bolt the winch into place, progressively tightening the bolts in a clockwise direction
8. Clean off surplus bedding compound
9. Refit the drum
10. Check that the winch is operating correctly

Note: Please refer to the special instructions provided with every Lewmar Self Tailing and Electric Winch. 3 speed winches are self draining, but care should be taken to ensure that the drain holes (on the underside of the base) are not blocked.

1 SPEED

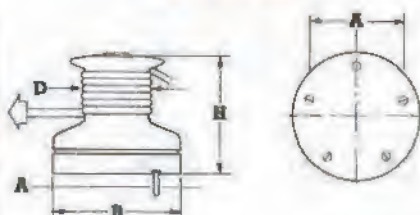

1

2 SPEED/3 SPEED

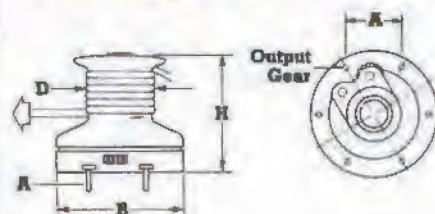

2

ELECTRIC WINCHES

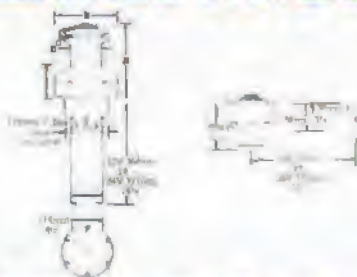

3

HALLIARD WINCH

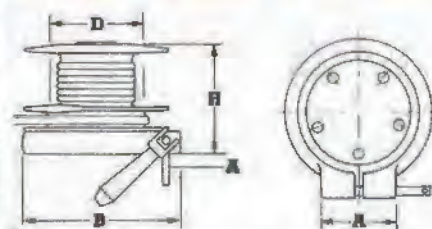

4

USING WAVEGRIP

Self-tailer convenience

If you've ever found yourself short of hands, space or just plain old musclepower, a couple of Lewmar self-tailing winches will make all the difference. By freeing you of the necessity to tail the sheet, a self-tailer enables you to use both hands to wind. Lewmar's patented Wavegrip concept is simple, safe and convenient.

A closer Look: Self-tailing with Lewmar's Wavegrip®

Ever since its introduction, Lewmar's patented Wavegrip mechanism has set the world standard for self-tailing performance. Other winchmakers had been playing with brawny, rope-chewing spring-loaded jaws; typically, Lewmar engineers used brains instead.

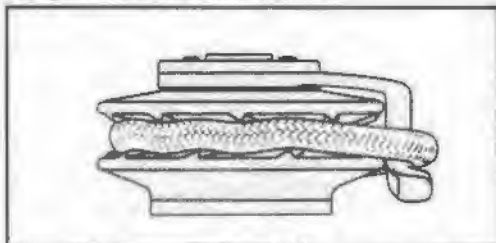

Wavegrip's carefully designed radial 'teeth', set in a wave form, takes ropes of different diameters without adjustment. Each rope finds its own optimum position and is held there, not by cumbersome spring-loaded jaws, but by the load in the line itself. The higher the load, the firmer the grip, yet releasing the rope requires little or no musclepower ... just ease it out of the Wavegrip jaws.

Wavegrip handles the rope gently, so there's less wear and tear on your sheets. Another big feature: the low-friction design means you can set the winch up before you tack, and tail the first few metres of slack in by hand ... through Wavegrip! Try that on any other self-tailer!



Self Tailers – How they work

1. The rope must be placed in the jaws correctly. The turn leading from the drum must be passed across the stripper mechanism as shown and placed into the jaws.
2. The winch must be mounted so that the loose sheet falls correctly into a secure stowage position. The position of the stripper arm can be adjusted to give correct feed off of the sheet.
3. There must be a minimum of 3 turns of rope on the barrel.
4. The jaws are designed to accept a range of rope diameters. The winch should only be used with ropes of the sizes recommended.

Range of rope diameters

Cat. Nos.	Circumference (mm)	(ins)	Diameter (mm)	(ins)
16ST	26/45	1/1 $\frac{3}{4}$	8/14	$\frac{5}{16}$ / $\frac{1}{2}$
30ST	26/45	1/1 $\frac{3}{4}$	8/14	$\frac{5}{16}$ / $\frac{1}{2}$
40ST	32/45	1 $\frac{1}{4}$ /1 $\frac{3}{4}$	10/14	$\frac{3}{8}$ / $\frac{1}{2}$
43ST	32/51	1 $\frac{1}{4}$ /2	10/16	$\frac{3}{8}$ / $\frac{5}{16}$
46ST	32/51	1 $\frac{1}{4}$ /2	10/16	$\frac{3}{8}$ / $\frac{5}{16}$
48ST	32/51	1 $\frac{1}{4}$ /2	10/16	$\frac{3}{8}$ / $\frac{5}{16}$
52ST	38/57	1 $\frac{1}{2}$ /2 $\frac{1}{4}$	12/18	$\frac{1}{2}$ / $\frac{3}{4}$
55ST	38/57	1 $\frac{1}{2}$ /2 $\frac{1}{4}$	12/18	$\frac{1}{2}$ / $\frac{3}{4}$
65ST	46/64	1 $\frac{3}{4}$ /2 $\frac{1}{2}$	14/20	$\frac{1}{2}$ / $\frac{11}{16}$

ADJUSTING SELF TAILERS

16, 30, 40, 43, 46 48, 52, 55, 65



1
Remove 4 screws, in top cap. Remove top cap.



1
Remove 4 socket head screws with a $\frac{1}{8}$ " A/F Allen Key. Lift off top cap.



2
Rotate stripper arm to required position, (it can be moved in $8 \times 45^\circ$ increments, with the winch bolted in place).



2
Remove both collets. Lift off stripper arm and place in required position, ensuring that the stripper arm is placed over the stripper ring in the jaw assembly.



3
Replace top cap and screws.



3
Replace collets, top cap and screws.

SERVICING

Single Speed 6,7,8



1

Remove circlip with a small screwdriver or knife blade.



Wash centre stem, roller bearings and drum bore with kerosene (paraffin). Dry with a non-fluffy cloth.



2

Lift off the drum. (Remove roller bearings and drum washer on model 8).



5

Oil pawls in top and bottom of the drum.



Ease out keyway and remove centre spindle.



Grease all parts lightly (including bearings on model 8).

Reassemble winch in reverse sequence. Check for correct operation.

SERVICING

2 Speed 16, 24, 30, 40



1

Remove circlip with a small screwdriver or knife blade.



4

Grease spindle and all other moving parts lightly.



2

Remove top cap, screws, crown and drum. Oil pawls in drum.



5

Remove gear spindle.



3

Remove bearings, drum washer and spindle. Clean all parts with kerosene (paraffin). Dry with a non-fluffy cloth, oil spindle pawls.



6

Remove gears, clean and oil gear pawls and lightly grease other parts.

Reassemble winch in reverse sequence. Check for correct operation.

2 Speed 43,46



1 Remove circlip with a small screwdriver or knife blade.



Lift out gear spindles and gears, wash and clean all parts.



2 Remove drum, top cap and crown. Refit crown (use anti-seize on crown screws). Remove bearings and drum washer.



Wash, clean, grease gears, bearings and centre spindle.



3 Remove collets from top of centre stem and remove centre spindle.



Oil pawls in both gears.
Reassemble winch in reverse sequence.
Check for correct operation.

SERVICING

2 Speed 52



1 Remove circlip with a small screwdriver or knife blade. Lift off drum. Remove crown (see p. 11-2).



2 Remove bearings and drum washer. Remove collets from top of centre stem and remove centre spindle.



3 Wash, clean all parts, grease all 8 bearings and all moving parts.



4 Oil pawls in both gear sets.



5 Lift out gear spindles and gears taking care that the gear bearings don't fall out. Reassemble winch in reverse sequence. Check for correct operation.



6 When reassembling take care to place the washers on the bottom of both gear sets (see also p. 21, 6). NOTE: It may help to remove centre stem from base (3 allen screws.)

3 Speed 48, 55, 65 Top Action



1 Servicing Top Cap Assembly

With drum already removed, lift off top cap assembly.



2 Remove large circlip, lift springs and remove plastic closing ring.



3 Check that closing ring and plunger pin are in good condition.

Assembly Warning: When reassembling pawl/ratchet gears, check for correct assembly. Look and check that the pawls seat in the matching ratchet faces.

Servicing Ratchet Gears



4 Correct location of ratchet gears.

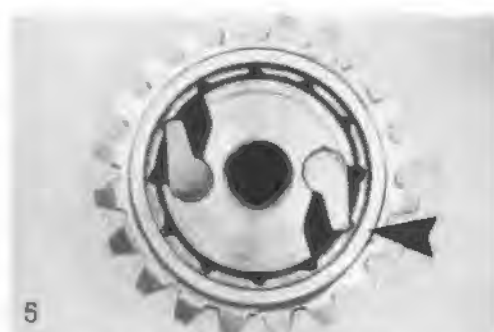

5 Incorrect location of ratchet gears.

SERVICING

3 Speed 48, 55, 65 Top Action



Remove circlip with a small screwdriver or knife blade.



Remove collets from top of centre stem and lift off centre stem.



Remove drum and top cap (see p. 13, 1-3), remove cross pin and clutch plate. Remove bearings, wash, clean and grease.



Ensure correct location of plastic end cap studs in pawl sockets.



3

Remove allen screws.



6

Remove gears with bearings, clean and oil pawls, and lightly grease all moving parts.

Reassemble winch in reverse sequence. Check for correct operation. See also p. 22, 6.

3 Speed 48, 55, 65 Top Action



1 Remove circlip, drum and top cap assembly. Remove cross pin and clutch plate.



2 Remove bearings, spacer, drum washer. Release outer screws in base and lift out centre stem assembly.



3 Remove 3 inner screws in centre stem, release bridge piece (below centre stem). Remove centre spindle, complete with all bearings. Wash, clean and grease.



4 Remove each gear, wash, clean, and grease all moving parts in winch. NOTE: When reassembling, gear order - mid-large-small.



5 Oil all pawls (including top cap - see also p. 13, 1-3), also pawls at bottom of centre spindle



6 Make sure gear spindle location pins are in the correct position before fitting bridge piece to centre stem. Place main spindle onto smallest gear.

SERVICING

No 1 Halliard



1 Remove the halliard, releasing the bitter end by unscrewing the $2 \times \frac{1}{4}$ " UNC grub screws.



Remove brake band and ratchet ring, clean with light abrasive and wash with kerosene (paraffin). Dry with a non-fluffy cloth.



2 Remove circlip with a small screwdriver or knife blade.



3 Remove drum, clean all parts, grease bearings and drive spindle lightly.

Primary and Secondary Drums - The main body of the halliard is stored on the primary drum and the turns should be stacked evenly. When the sail is nearly fully hoisted, i.e. within 2 or 3 feet of the black band the final turns should be wound on the secondary drum to avoid crushing the wire.

Warning

The brake should be tightened firmly before hoisting the sail. When lowering the sail the brake is released as described and the rate of descent controlled with the brake lever. **THE HANDLE MUST NOT BE LEFT IN THE WINCH WHEN THE BRAKE IS RELEASED AS IT WILL REVOLVE. THIS IS DANGEROUS AND CAN CAUSE INJURY.** OIL OR GREASE MUST NOT BE APPLIED TO THE BRAKE MECHANISM ON ANY HALLIARD WINCH.

NOTE:

When reassembling, ensure pawls engage correctly into ratchet ring.

Reassemble winch in reverse sequence. Check for correct operation.

Single Speed 16ST



1 Remove top cap, collets, stripper arm and drum.



Remove gear spindle, output gear and drive gear. Wash and clean.



2 Remove self tailing jaw assembly, clean all parts, oil pawls in drum and refit.



Start to reassemble. Grease all moving parts lightly and oil pawls in main spindle. Replace bearings and drum.



3 Remove bearings, drum washer and spindle, wash and clean all parts.
Reassemble winch in reverse sequence.
Check for correct operation.



6 Make sure stripper arm is over stripper ring in jaw assembly (see p. 19, 6). Replace collets by lifting centre spindle. Replace top cap and screws.

SERVICING

2 Speed 30ST, 40ST



Remove 4 screws in top cap. Remove top cap.



Lift out gear spindles, remove gears. Wash, clean and grease the gears.



Remove collets, lift out centre spindle.



Oil all pawls.



Remove stripper arm, drum. Release self tailing jaw assembly. Clean and refit. Remove bearings and drum washer. Wash, clean and grease bearings. Reassemble winch in reverse sequence.



When reassembling take care that 'small' gear is on top (see pic) and stripper arm is over stripper ring in jaw assembly (see p. 19, 6). Check for correct operation.

2 Speed 43ST, 46ST



1
Remove 4 screws in top cap. Remove top cap.



Lift out gear spindles, remove gears. Wash, clean and grease the gears.



2
Remove collets, lift out centre spindle.



5
Oil all pawls.



3
Remove stripper arm, drum. Release self tailing jaw assembly, clean and refit. Remove bearings and drum washer. Wash, clean and grease bearings.



6
When reassembling take care that stripper arm is over stripper ring in jaw assembly. Reassemble winch in reverse sequence. Check for correct operation.

SERVICING

2 Speed 48ST



1 Remove 4 screws in top cap ($\frac{1}{4}$ " A/F Allen Key). Remove top cap.



4 Lift off centre stem upper. Remove centre spindle, unscrew plastic end cap and oil pawls at end of centre spindle.



3 Remove stripper arm. Lift off drum assembly, release self tailing jaw assembly, clean and refit. Remove bearings and drum washer. Wash, clean and grease bearings.



5 Remove gears, oil pawls, grease all moving parts. When reassembling carefully locate centre spindle in gears before replacing centre stem upper.

Assembly Warning

When reassembling pawl/ratchet gears ensure correct assembly. Look and check that pawls seat in the matching ratchet faces (see also p. 13, 4-5).



3 Remove allen screws in centre stem. Ease out plastic key.

Reassemble winch in reverse sequence. Make sure stripper arm is over stripper ring in jaw assembly (see p. 19, 6). Check for correct operation.

2 Speed 52ST



1
Remove 4 screws in top cap ($\frac{1}{4}$ " A/F Allen Key). Remove top cap.



4
Lift out gear spindles and gears taking care that the gear bearings don't fall out.



2
Remove stripper arm. Lift off drum assembly, release self tailing jaw assembly, clean and refit. Remove collets and lift out centre spindle.



5
Oil pawls in both gear sets.



3
Remove bearings and drum washer. Wash, clean and grease bearings.
Reassemble winch in reverse sequence. Check for correct operation.



6
When reassembling take care to place the washers on the bottom of both gear sets and that stripper arm is over stripper ring in jaw assembly (see p. 12-6 and p. 19-6).

SERVICING

2 Speed 55ST, 65ST



1
Remove 4 screws in top cap ($\frac{1}{8}$ " A/F Allen Key). Remove top cap.



2
Remove collets, stripper arm. Lift off drum assembly, releasing self tailing jaw assembly, clean and refit.



3
Remove bearings, spacer, drum washer. Release outer screws in base and lift out centre stem assembly.



4
Remove 3 inner screws in centre stem, release bridge piece (below centre stem). Remove centre spindle, complete with bearings. Wash, clean and grease.



5
Proceed and read p. 15, 4-6, p. 19, 6.

Warning

The winch is self draining, but care should be taken to ensure that the drain holes (on the underside of the base) are not blocked.
Do not drop drum onto centre stem.

Reassemble winch in reverse sequence.
Check for correct operation.

3 Speed 55/3, 65/3, 55/3ST, 65/3ST



1

General service as described on p. 15, 1-6 and p. 22, 1-6. (For adjustment ease plastic cover off bottom push button (in base) with a small screwdriver). *see 6.



4

Plunger shown in engaged position. Oil and work plunger so that oil migrates and smooth action results.



2

Close up showing nut and screw. Plunger is adjusted to effect smooth gear selection. (If in doubt contact nearest Lewmar office).



5

When reassembling complete centre stem to base. The gear change fork (indicated) must line up with the plunger when the plunger is disengaged.



Adjustment and locking of plunger assembly using box spanner and screwdriver. Tighten nut without moving screw position.

Warning

The winch is self draining, but care should be taken to ensure that the drain holes (on the underside of the base) are not blocked.

Do not drop drum onto centre stem.

***If gear change works smoothly leave alone and proceed to 4.**

6

Reassemble winch in reverse sequence. Check for correct operation.

SERVICING

Electric Winches

For general servicing instructions, follow pages 20, 22 and 23. For specific problems, follow the chart below, or contact your nearest Lewmar office.

Fault Finding Guide

Symptom	Probable Cause	Remedy
Winch works only in one speed	Motor polarity	Check wiring polarity to motor and reverse if necessary
Winch does not work at all	a. Bad connection	Check all wiring connections especially to battery
	b. Blown fuse or circuit breaker	Check circuit breaker
		Check fuse on encapsulated PC board and replace if blown
		NOTE: Do not alter or interfere with sealed trimmer
		If fuse blows again immediately – contact your Lewmar Agent
c. Micro-switch in control unit not operating	Check that air switch below is operating the micro-switch in control unit	
	Adjust for sensitivity if necessary	
d. Insufficient power	Check battery for charge	
e. Worn brushes or brush hung up	Check brushes and commutator on motor and release or replace if necessary	

NOTE:

If the winch requires further servicing, please contact your nearest Lewmar office.



YOUR LEWMAR GUARANTEE.

Guarantee Counterfoil

The following particulars will be registered under the terms of our guarantee.

Name _____

Address _____

Boat Type _____

LOA _____

Built by _____

Winches

Model _____

Model _____

Model _____

Model _____

Model _____

Model _____

Winches Supplied (Please tick)

came with boat

fitted by boatyard/dealer

purchased from dealer/chandler

Date _____

YOUR LEWMAR GUARANTEE.

The following particulars will be registered under the terms of our guarantee.

Name _____

Address _____

Boat Type _____

LOA _____

Built by _____

Winches

Model _____

Model _____

Model _____

Model _____

Model _____

Model _____

Winches Supplied (Please tick)

came with boat

fitted by boatyard/dealer

purchased from dealer/chandler

Please complete reverse also

Date _____



NOTE

Please return to your nearest Lewmar office – shown overleaf

FURTHER INFORMATION

I am interested to receive more details of System Lewmar to compliment my Winches. Please send me details and brochures, as shown on the back page.

- Deck Hardware
- Super Hatch
- Winches
- Performance Winches
- Service Manual IV
- Service Manual V
- Service Manual V Specials
- Navtec Rigging
- Navtec Hydraulics
- Commander Hydraulic Power Packs
- Portlight
- New Products
- Newsletter
- Ball Bearing Handles
- Performance Deck Hardware
- Self Tailing Winches

Lewmar Subsidiary Companies, Regional Distributors and Distributors/Service Centres in the USA

LEWMAR

Head Office:-
Lewmar Marine Limited
Southmoor Lane, Havant
Hampshire, PO9 1J, England
tel Havant (0705) 471841.3
fx 86542 LEWMAR G

Subsidiaries:-

Lewmar Sud Europe SARL
Avenue Louis Lumiere
21 de Penary
17000 La Rochelle, France
tel (46) 44 4945
fx 792282 YACHTEQ F

Lewmar Marine Inc. (East Coast)
23 Broad Common Road, Bristol
Rhode Island 02809 USA
tel (401) 253-6900
fx 7103871155 LEWMAR BROL

Lewmar Marine Inc. (West Coast)
876 West 76th Street
Newport Beach, California 92663
USA
tel (714) 631-7251
fx 683604 LMRWC

Lewmar Marin AB
Box 5075, S. 172 06 Sundbyberg
Sweden
tel (06) 95 04 75
fx 63184 LEWMARS

Lewmar Marine Limited
1416 Spadina Road, No. 2 Oakville
Ontario, Canada L6L 5M1
tel (416) 827-9910
fx 08992257 LEWMAR CIA GKVL

Lewmar World Service

Full service care, spare parts
and assistance are available
worldwide. In case of any
difficulty please contact your
nearest Lewmar office or
distributor.

Regional Distributors:

UK
Marine Yacht Fittings Limited
Claydon Way, Eastleigh
tel (043) 810 4549

X-M Yachting
Patergate, East Sussex
tel 0323 870052
fx 878744 XMYOTS G

Yacht Tesis Limited
Bunhill Row, Crouch, Essex
tel 0621 732235
fx 995494 YCOTES G

ARGENTINA
Delta Finns Marine SRL
Pav. de Buenos Aires
tel 745 3562
fx 26882 CAMOU AF

NAVITRONIC
Buenos Aires
tel
fx 36085 NAVI AR

AUSTRALIA
Warwick Hobbs & Associates
Brighton Beach
Victoria 3186
tel (03) 592 7171
fx 38077 YACHT AA

AUSTRIA / EASTERN EUROPE
Horst Welebnay
A 4020 Linz
tel (033) 42566 7
fx 22276 WELLEBA A

BRAZIL
O. Veloso Importacao
E Exportacao Ltda
Rio de Janeiro
tel (21) 232 2775-3025
fx 210928 VLEX BR

CANARIES ISLAND
Nordport
Simo Cruz de Tenerife
34 322264874
fx 98304

CHILE
AMF Astilleros
Santiago
tel 22 2571/2212116
fx 340976 AMTSA CK

CYPRUS
Mezoury Divers Co. Ltd
Limassol
tel 051-65492
fx 4976 MERDIVECY

DENMARK
Munter Marine A/S
Copenhagen
tel (01) 37 66 00
fx 27591 DOMION DK

CARIBBEAN
Hi-Tech Caribbean Ltd
Tortola, BV
tel 503-484-3811
fx 7969 HDSAIL VB

Goodwood Marine
Trinidad, West Indies
tel 63-24612
fx 276 FITWIR.WG

Ship Shop Martinique
Martinique
tel 972000
fx 912302

FINLAND
Oy Veutek AB
Espoo
tel (09) 450 544
fx 121269 VSTEK SF

GERMANY
Marta Hohorst
Bismarck 77
tel (0431) 33 10 85
fx 24924 MAROS DI

GIBRALTAR
H. Sheppard and Co. Ltd
Waterport
tel (350) 77181
fx 3324 MARINA GK

GRECE
Jordan P. Piliadis
Pigeus
tel (1) 4521647
fx 211092 TPI GP

HOLLAND / BELGIUM / LUXEMBOURG
Marquip BV
Veldhoven, Nederland
tel (06) 6274 3900
fx 42937 MARQU NL

HONG KONG
Far East Yacht Specialists Limited
Hong Kong
tel 5 229334 / 5 225752
fx 55335 KREMA HK

ITALY
Deck Marine
Mistral
tel (02) 3047228 / 3040631
fx 330599 YACHT I

JAPAN
Nakamura Sangyo Kogyo Co. Ltd.
Yokohama
tel (45) 86 10 94
fx 3822853 REPRU J

KOREA
Dong Jin Trading Corporation
Seoul
tel 447 9067 B B
fx K25606 BESTON

MAINTA
Ripard, Lavinia and Ripard Ltd.
tel 0219 31553
fx 984 YOTS MW

NEW CALEDONIA

Marine Com2
Noumea
tel: 426222
fx: 333 57

NEW ZEALAND

Marine Power and Service
Auckland
tel: (0) 77335
fx: 31817 SEAGRAF

NORWAY

With Marine A/S
Oslo
tel: (0) 851934

PORTUGAL

A Pereira Jordao Lda
Porto
tel: 30947 819
fx: 22509 JORDAO P

PHILIPPINES

Top Service Inc.
Manila
tel: 59 78 71 59 98 73
fx: 727171 SYC PH

SINGAPORE

American Marine (S) Pte Ltd
Jurong Town
tel: 2850511
fx: AMSING 85 21294

SOUTH AFRICA

Central Boating World
Cape Town
tel: 21 240026
fx: 5 26712 SA

SPAIN

La Industria Velas Mares
Barcelona
tel: 431400
fx: 51654 LIVME

SW: LANKA

Consolidation Yacht
Colombo
tel: 35008 35664
fx: 168 RVSLCE

SWEDEN

Lewmar Marin AS
Lindome
tel: 46 319 0795

SWITZERLAND

Bucher and Watz SA
Neuchâtel
tel: (0) 28 336262
fx: 952569 BUWA CH

TAIWAN

Chia Shun Trading Co Ltd
Taipei
tel: (02) 5012953 6
fx: 19579 CHAISHAN

URUGUAY

Rozacio Carrubelli/Barcos
Montevideo
tel: 21 53 27
fx: 3814 CANUY

USA

R. B. Grove Inc.
Miami
tel: (305) 6845430
fx: 230-515615 GROVE MIA

ZIMBABWE

Garber Industrial Marine Centre
Harare
tel: 733880
fx: 4266 MHGOLF ZW

Sub Distributors:**AUSTRALIA**

Harcades and Boatings only -
Jolo Marine Pty. Ltd.
Beverly
tel: (08) 774 2256
fx: AAS2704
Watches and Hardware only -
NSW and Queensland

Peter Green Shipchandler

(Australia) Pty. Ltd.
Sydney
tel: (02) 997 8411
fx: 27533 POS

CANADA**Firelay Imports**

Vancouver
tel: 985 87443

Tom Taylor & Co. Ltd.

Toronto
tel: (416) 580 1911

FRANCE

Lewmar Sud Europe Bart
Cannes
tel: 93 47 7285

HOLLAND/BELOW**LUXEMBOURG**

Luxembourg Sport BV
Sneek
tel: 05130 1101
fx: 46074 LANK NL

**USA - Manufacturers and
Representatives**

R. B. Grove Inc.
261 Southwood Way Street
Miami, Florida 33132
tel: (305) 6845430
fx: 230-515615 GROVE MIA

R. B. Grove Inc.
2487 61st Street North
Building A, No. 104
Largo, Florida 33544
tel: (813) 530 1429

D. A. Stewart & Co.
101 Annapolis, Maryland
tel: (301) 281 4516

Gray Allan & Associates
2400 Westlake Avenue North
Seattle WA 98109
tel: (206) 285 9644

USA - Distributors**CALIFORNIA**

Fox Marine Specialties
Long Beach
tel: (213) 426 7111

Malcraft Sacramento
tel: (916) 428 3634

Malcraft Cleary
tel: (213) 637 0569

Pen Supply Santa Cruz
tel: (408) 476 1900

Sailing Supply, San Diego
tel: (714) 523 0159

Swendson Boat Works
Alameda
tel: (415) 522 7860

SOUTH CAROLINA
Coveys Marine Charleston
tel: (803) 747 8122

CONNECTICUT

Kellog Marine Supply
Old Saybrook
tel: (203) 388 4277

New London Marine Supply
New London
tel: (203) 442 2016

FLORIDA

Gen-Mar Marine Supply Inc.
Largo
tel: (813) 526 1885

Johnson Boats 20 Petersburg
tel: (813) 877 3220

Lewis Marine Supply
 Ft Lauderdale
tel: (305) 523 4311

MacK-Shaw Sail Systems
 Ft Lauderdale
tel: (305) 522 6767

Phillips Marine Miami
tel: (305) 643 8445

GEORGIA

Grylls's Marina Inc Atlanta
tel: (404) 485 0181

ILLINOIS

Barclay Marine Distributors
Chicago
tel: (312) 929 5728

INDIANA

Grylls's Marina Inc Southport
tel: (819) 234 4707

LOUISIANA

Donovan Boat Supplies
New Orleans
tel: (504) 466 1731
Grylls's Marina Inc Sliderville
tel: (719) 323 9341

MARYLAND

Fordson Boat Supplies Annapolis
tel: (410) 887 2691

MAINE

Maris Company Portland
tel: (207) 775 3800

Morris Marine Portland
tel: (207) 586 8484

MICHIGAN

Barclay Marine Distributors
Detroit
tel: (313) 571 1000

Barclay Marine Distributors
Grand Rapids
tel: (616) 243 6884

John Brewer Company Muskegon
tel: (616) 864 8774

Thomas Hardware
Grosse Pointe Park
tel: (313) 886 9284

MINNESOTA

Barclay Marine Distributors
St Paul
tel: (612) 223 6464

MISSOURI

Coveys Marine Kansas City
tel: (816) 481 3100

NEW JERSEY

General Marine Supply Inc.
Egg Harbour City
tel: (609) 985 8510

NEW YORK

East End Supply Company
Greenport
tel: (516) 477 1900

Howard Baker Co Buffalo
tel: (716) 654 5867

Oyster Bay Boat Shop
Oyster Bay
tel: (516) 945 0700

Roberts Hardware Union
tel: (315) 797 3250

TEXAS

Blackburn Equipment Company
Houston
tel: (713) 747 5180

Orlin's Marine Inc Dallas
tel: (214) 267 3066

WASHINGTON

Fisheries Supply Company
Seattle
tel: (206) 822 4482

Kobrand/Windward Mark
Seattle
tel: (800) 728 0200

Marland Enterprises Seattle
tel: 206 284 5996

Lewmar Service Centers - USA**CALIFORNIA**

Bay Riggers San Diego
tel: (619) 522 8762

Lewmar Marine Inc (West Coast)
Newport Beach
tel: (714) 801 7280

Sea Tek, Marine Division
Seattle
tel: (206) 266 0210

SOUTH CAROLINA

Southwest Boatworks
Mt. Pleasant
tel: (803) 694 4710

CONNECTICUT

Macdonald Yacht Rigging
Stamford
tel: (203) 325 5431

Pink's Paint Marine, Westport
tel: (203) 285 1708

Waters's Marine, Stratford
tel: (203) 652 2807

FLORIDA

Florida Rigging and Hydraulics
Florida Beach
tel: (305) 544 4511

MacK-Shaw Sail Systems Inc.
 Ft Lauderdale
tel: (305) 523 6767

Sailing Services Miami
tel: (305) 856 1889

ILLINOIS

Pullerson Marine, Oak Park
tel: (312) 771 2411

MAINE

Hardy Boat Service
Portland Forestry
tel: (603) 779 5100

Wayfarer Marine Corp. Camden
tel: (207) 529 6275

Falmouth Marine, Falmouth
tel: (617) 542 4300

MARYLAND

Chapman's Rigging Annapolis
tel: (410) 261 0626

MICHIGAN

Thomas Hardware Co.
Grosse Pointe Woods
tel: (313) 928 8624

RHODE ISLAND

Lewmar Marine Inc (East Coast)
Providence
tel: (401) 523 3200

New England Yacht Riggers
East Greenwich
tel: (609) 844 1111

TEXAS

Cedar Mills Marine, Corsicana
tel: (414) 888 4257

Lakeland Marine Inc, San Antonio
tel: (717) 394 3211

VERMONT

Shelburne Shipyard Shelburne
tel: (802) 925 3036

WASHINGTON

Northwest Yacht Repair Seattle
tel: (206) 285 3480



The range of catalogues available from your dealer, indicate on your guarantee card if you would like to receive your copy direct, or more information on other Lewmar products.



Distributed by:-