

# System A

**Typical boat size:**  
 Monohulls: length 11.3 - 15.2 m (37 - 50');  
 mainsail area under 56 m<sup>2</sup> (600 ft<sup>2</sup>)

Multihulls: length 9.1 - 12.2 m (30 - 40');  
 mainsail area under 46 m<sup>2</sup> (500 ft<sup>2</sup>)

About CB and slider Battcar systems: See feature pages at beginning of this section.



Tofinou 12, 12 m (39.37'), Chantier Naval Latitude 46,  
 naval architect: Joubert / Nivelte © Chantier Naval Latitude 46



3811



3883



3882



3881



3830



3829



3831



3812

## CB BALL BEARING CARS



3827



3803



3802



3828



1777

## SLIDER CARS

Part No.	Description	Length		Width		Weight		Max headboard thickness		Max batten			Batten	Maximum working load	
		in	mm	in	mm	oz	g	in	mm	Width	Ø	in		mm	lb
<b>CB Cars: Typical Boat Length: Monohulls 11.3 - 15.2 m (37 - 50'); Multihulls 9.1 - 12.2 m (30 - 40')</b>															
3811*	Headboard car assembly	8 <sup>9</sup> / <sub>8</sub>	213	2 <sup>1</sup> / <sub>4</sub>	57	18	518	<sup>9</sup> / <sub>16</sub>	14	—	—	—	—	1600	725
3812*	Intermediate car	2 <sup>1</sup> / <sub>4</sub>	57	2 <sup>1</sup> / <sub>4</sub>	57	4	109	—	—	—	—	—	—	—	—
3829*	Battcar/10 mm stud**	2 <sup>1</sup> / <sub>8</sub>	73	2 <sup>1</sup> / <sub>4</sub>	57	6	157	—	—	—	—	—	—	600	272
3830*	Battcar/40 mm receptacle	2 <sup>1</sup> / <sub>8</sub>	73	2 <sup>1</sup> / <sub>4</sub>	57	9	253	—	—	1 <sup>1</sup> / <sub>8</sub>	41	<sup>5</sup> / <sub>8</sub>	16	Flat/round	600 272
3881	Battcar/12 mm stud**	2 <sup>1</sup> / <sub>8</sub>	73	2 <sup>1</sup> / <sub>4</sub>	57	6.4	182	—	—	—	—	—	—	600	272
3831	Universal Battcar**	2 <sup>1</sup> / <sub>8</sub>	73	2 <sup>1</sup> / <sub>4</sub>	57	4.3	122	—	—	—	—	—	—	600	272
3882	Long batten car/12mm stud**	4 <sup>1</sup> / <sub>8</sub>	105	2 <sup>1</sup> / <sub>4</sub>	57	8.2	232	—	—	—	—	—	—	875	397
3883	Reef car	4 <sup>1</sup> / <sub>8</sub>	105	2 <sup>1</sup> / <sub>4</sub>	57	6.1	174	—	—	—	—	—	—	875	397
<b>Slider Cars: Typical Boat Length: Monohulls 11.3 - 15.2 m (37 - 50'); Multihulls 9.1 - 12.2 m (30 - 40')</b>															
3827	Headboard car assembly	6	153	1 <sup>3</sup> / <sub>8</sub>	35	10	269	<sup>9</sup> / <sub>16</sub>	14	—	—	—	—	1600	725
1777	Low-load intermediate car‡	2	51	1 <sup>1</sup> / <sub>4</sub>	32	1.1	32	—	—	—	—	—	—	200	91
3828	Intermediate car	1 <sup>3</sup> / <sub>4</sub>	44	1 <sup>3</sup> / <sub>8</sub>	35	1.6	45	—	—	—	—	—	—	350	159
3802	Battcar/10 mm stud**	1 <sup>3</sup> / <sub>4</sub>	44	1 <sup>3</sup> / <sub>8</sub>	35	2.8	80	—	—	—	—	—	—	350	159
3803	Battcar/40 mm receptacle	1 <sup>3</sup> / <sub>4</sub>	44	1 <sup>3</sup> / <sub>8</sub>	35	6.4	181	—	—	1 <sup>1</sup> / <sub>8</sub>	41	<sup>5</sup> / <sub>8</sub>	16	Flat/round	350 159

See page 35 for replacement balls. \*Available as a non-CB car on a car loader to run on a non-CB style track supplied before 2003. Add .NW to end of part number.

158 ‡ Max. sail area: Monohull 33 m<sup>2</sup> (350 ft<sup>2</sup>), Multihull 28 m<sup>2</sup> (300 ft<sup>2</sup>). \*\*Batten receptacle not included.

# System A

About CB and slider Battcar systems: See feature pages at beginning of this section.

## Mast Track

3807 track mounts to mast using a unique slug system that allows mast-up installation.

Use flanged track when mounting to carbon spars. Track features a groove for racing sails with boltropes or slugs.

Part No.	Description	Length		Weight		Fastener spacing		Fastening method
		in	m	oz/ft	g/m	in	mm	
3807	Slug-mount track	80 <sup>3</sup> / <sub>4</sub>	2.05	4.44	413	4 <sup>1</sup> / <sub>16</sub>	125	Mounting slugs
3878.2M	Flanged track	78 <sup>3</sup> / <sub>4</sub>	2	6.7	626	—	—	Adhesive
3878.6M	Flanged track	236 <sup>1</sup> / <sub>4</sub>	6	6.7	626	—	—	Adhesive

## Traveler Track: Drill/Tap

For masts without internal sail track, attach 2720 Small Boat traveler track by drilling and tapping the spar. Join track sections with splice links. Order one per track section. Order one low-beam endstop (sold in pairs).

Part No.	Description	Splice link	Endstop	Ordering information	Fastening method
2720	Small Boat track	2724	263	page 122	Drilling and tapping

## Mounting Kits and Endstops

Mounting kit slugs are available for flat or round mast grooves. Order one kit per track section.

Use screwpin endstop to easily remove cars and mainsail. Order one kit only.

### MOUNTING KIT

3804  
3805  
3806



### ENDSTOP KIT/FIXED

3808  
3809  
3810



### ENDSTOP KIT/SCREWPIN

3824  
3825  
3826



Mainsail luff length	Number of 3807 track sections	
	ft*	m*
26'4" - 33'	8.03 - 10.06	5
33'1" - 39'9"	10.08 - 12.11	6
39'10" - 46'5"	12.13 - 14.16	7
46'6" - 53'2"	14.19 - 16.21	8
53'3" - 59'11"	16.24 - 18.26	9

\*Track extends above sail luff. Using screwpin endstop kits will increase lengths.

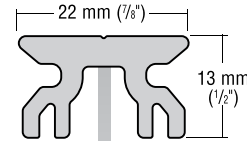

3807 Slug-mount track

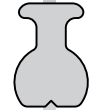

3804 Mounting kit  
3808 Endstop kit/fixed  
3824 Endstop kit/screwpin



3805 Mounting kit  
3809 Endstop kit/fixed  
3825 Endstop kit/screwpin

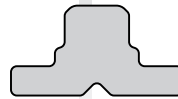

3806 Mounting kit  
3810 Endstop kit/fixed  
3826 Endstop kit/screwpin

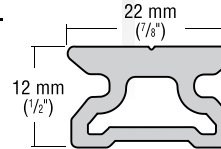

2720 Small Boat traveler track

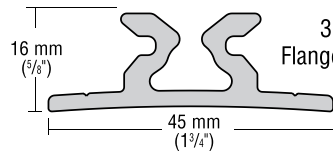

3878 Flanged track

## Track Mounting Kits: Slug Mount\*

Part No.	Description	Mounting slug				Connector slug				Fits flat mast groove gap					
		Length		Weight		Length		Weight		Connector		Min		Max	
		in	mm	oz	g	in	mm	oz	g	slugs/kit	in	mm	in	mm	
3804	Round mast groove	3/4	19	.14	4	15	2 3/8	67	.54	15	1	—	—	—	—
3805	Flat mast groove	3/4	19	.17	5	15	2 3/8	67	.60	17	1	3/16	8	7/16	11
3806	Wide flat mast groove**	3/4	19	.25	6	15	2 3/8	67	.94	23	1	7/16	11	5/8	16

## Endstop Kits: Slug Mount\*

Part No.	Description	Track end length		Weight		Mounting slugs/kit
		in	mm	oz	g	
3808	Round mast groove/fixd (pair)	—	—	.5	14	2
3809	Flat mast groove/fixd (pair)	—	—	.52	15	2
3810	Wide flat mast groove/fixd (pair)**	—	—	.67	19	2
3824	Round mast groove/screwpin	8	203	5.4	155	3
3825	Flat mast groove/screwpin	8	203	5.5	157	3
3826	Wide flat mast groove/screwpin**	8	203	6.1	174	3

\*Includes M5 X .8 X 20/25 mm or 25 mm fasteners. \*\*For Selden mast slugs contact Harken.