

Teardrop Blocks

Teardrop blocks are ideal as masthead leads and in other applications where limited articulation or direct attachment is desired. When attached to a compatible padeye, teardrop blocks will not hit the deck when lines are slack, but allow enough movement to ensure fairleads when jumping halyards. They are often used on permanent backstays of fractionally rigged boats where the backstay can be spliced directly to the head of the block.

About Black Magic Air blocks: see feature pages at beginning of this section.



3223
3240
3253

Part No.	Description	Sheave Ø		Length		Weight		Clevis pin Ø		Max line Ø		Maximum working load		Breaking load		Use padeye
		in	mm	in	mm	oz	g	in	mm	in	mm	lb	kg	lb	kg	
57 mm																
3223	Padeye/high-load	2 ¹ / ₄	57	3 ³ / ₈	86	3.92	111	5 ¹ / ₁₆	8	3 ¹ / ₈	10	2500	1134	5000	2268	627
75 mm																
3240	Padeye	3	75	4 ¹ / ₁₆	113	8.72	247	3 ³ / ₈	10	9 ¹ / ₁₆	14	5000	2268	10000	4535	648/689
100 mm																
3253	Padeye	4	100	5 ¹³ / ₁₆	148	16	454	1 ¹ / ₂	12.7	5 ¹ / ₈	16	7500	3402	15000	6804	—

Footblocks

Use footblocks to redirect lines on the deck. Footblocks with lockoffs temporarily secure sheets.

Either metric or imperial flathead fasteners may be used for mounting and are not exposed.

About Black Magic Air blocks: see feature pages at beginning of this section.



3220
3234
3249
3257
3263



3222
3235
3250
3258



3221
3236



3237

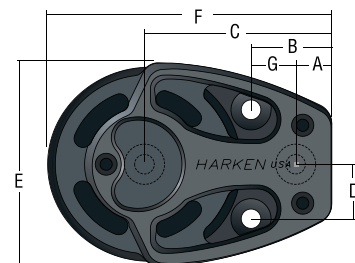

Dimensions

Part No.	A		B		C		D		E		F		G	
	in	mm	in	mm	in	mm	in	mm	in	mm	in	mm	in	mm
3220/3221/3222	3 ¹ / ₈	9.5	7 ¹ / ₈	22.5	2 ¹ / ₃₂	51.5	5 ¹ / ₈	16	2 ⁵ / ₁₆	59	3 ³ / ₁₆	84	1 ¹ / ₂	13
3234/3235/3236/3237	1 ⁵ / ₃₂	11.5	1 ¹ / ₈	28.5	2 ³ / ₄	70.5	1 ³ / ₁₆	21	3	77	4 ⁵ / ₁₆	110	2 ¹ / ₃₂	17
3249/3250	9 ¹ / ₁₆	14.5	1 ¹⁵ / ₃₂	37.5	3 ³¹ / ₃₂	92.5	1 ³ / ₃₂	28	3 ¹⁵ / ₁₆	100	5 ⁵ / ₈	143	2 ⁹ / ₃₂	23
3257/3258	2 ¹ / ₃₂	17	1 ²⁹ / ₃₂	45	4 ⁷ / ₁₆	113	1 ¹¹ / ₃₂	34.5	5 ¹ / ₃₂	127.5	6 ²⁹ / ₃₂	176	1 ³ / ₃₂	28
3263	1 ³ / ₁₆	20.5	2 ¹ / ₃₂	53.5	5 ³ / ₃₂	129	1 ³ / ₈	41	6 ¹ / ₁₆	154	8 ¹ / ₃₂	204	1 ⁵ / ₁₆	33

Part No.	Description	Sheave Ø		Length		Height		Weight		Max line Ø		Maximum working load		Breaking load		Fasteners (FH)	
		in	mm	in	mm	in	mm	oz	g	in	mm	lb	kg	lb	kg	in	mm
57 mm																	
3220	Single/high-load	2 ¹ / ₄	57	3 ⁵ / ₁₆	84	1	25	4.29	122	7 ¹ / ₁₆	12	2500	1134	5000	2268	4 x 1 ¹ / ₄	4 x 6
3221	Single/high-load/lockoff*	2 ¹ / ₄	57	3 ³ / ₁₆	84	1	25	5.44	154	7 ¹ / ₁₆	12	2500	1134	5000	2268	4 x 1 ¹ / ₄	4 x 6
3222	Double/high-load	2 ¹ / ₄	57	3 ⁵ / ₁₆	84	1 ¹³ / ₁₆	46	7.6	215	7 ¹ / ₁₆	12	1650	750	3300	1500	4 x 1 ¹ / ₄	4 x 6
75 mm																	
3234	Single	3	75	4 ³ / ₈	111	1 ¹ / ₄	32	9.76	277	9 ¹ / ₁₆	14	5250	2380	10500	4762	4 x 5 ¹ / ₁₆	4 x 8
3235	Double	3	75	4 ³ / ₈	111	2 ¹ / ₄	57	17.28	490	9 ¹ / ₁₆	14	3465	1572	6930	3143	4 x 5 ¹ / ₁₆	4 x 8
3236	Single/lockoff*	3	75	4 ³ / ₈	111	1 ¹ / ₄	32	11.28	320	9 ¹ / ₁₆	14	5250	2380	10500	4762	4 x 5 ¹ / ₁₆	4 x 8
3237	Double/lockoff*	3	75	4 ³ / ₈	111	2 ¹ / ₄	57	20.24	574	9 ¹ / ₁₆	14	3465	1572	6930	3143	4 x 5 ¹ / ₁₆	4 x 8
100 mm																	
3249	Single	4	100	5 ⁵ / ₈	143	1 ⁵ / ₁₆	33	19.57	555	5 ¹ / ₈	16	7500	3402	15000	6803	4 x 3 ¹ / ₈	4 x 10
3250	Double	4	100	5 ⁵ / ₈	143	2 ¹ / ₁₆	62	34.1	967	5 ¹ / ₈	16	4950	2250	9900	4500	4 x 3 ¹ / ₈	4 x 10
125 mm																	
3257	Single	5	125	6 ¹⁵ / ₁₆	176	1 ¹¹ / ₁₆	43	34.29	972	3 ¹ / ₄	19	11000	4990	22000	9977	4 x 1 ¹ / ₂	4 x 12
3258	Double	5	125	6 ¹⁵ / ₁₆	176	2 ¹³ / ₁₆	71.5	60.35	1711	3 ¹ / ₄	19	7260	3292	14520	6585	4 x 1 ¹ / ₂	4 x 12
150 mm																	
3263	Single	6	150	8 ¹ / ₁₆	205	1 ⁷ / ₈	48	58.58	1661	1	25	15000	6818	30000	13636	4 x 5 ¹ / ₈	4 x 16

*Lockoffs are intended to hold lines temporarily and should not be used in place of line stoppers or clutches.